

ASSEMBLY INSTRUCTIONS

Tools Required: Philips Screwdriver

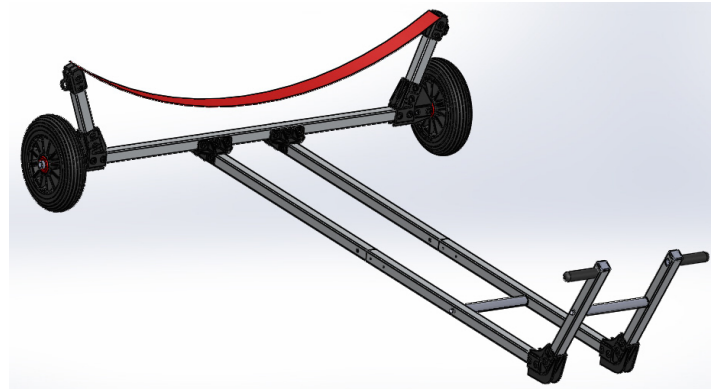

Step 1: Axle Tube & Wheel Shaft Assembly

1. Connect side tubes and wheel shafts to axle tube through axle fittings. Make sure the Dynamic label faces aft.
2. Connect sling to side tubes through sling fittings.

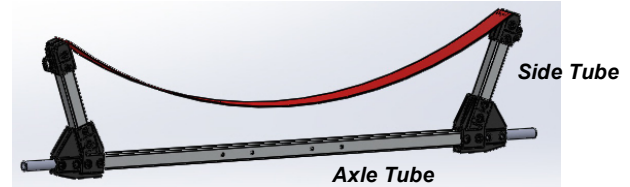

Step 2: Tongue & Bow Tube Assembly

1. Connect Forward Tongue Tubes to Bow Tube Assemblies via the Elbow Fitting
2. Insert threaded rod into keel tube and secure with acorn nuts on both ends.
3. Connect both aft tongue tubes to forward tongue tubes at splice joints.

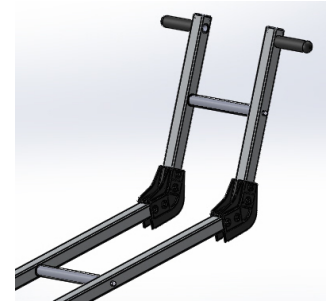

Step 3: Final Assembly

1. Connect both tongue tubes to axle tube through cross fittings. Make sure Dynamic label on the axle tube faces aft.
2. For a quick dolly- breakdown, use wing nuts and hex head machine screws as shown in picture.
3. Slide wheels onto wheel shafts by depressing snap button.
4. Wheels can be secured on the dolly by inserting the enclosed short flat head machine screws under the snap buttons.
5. Tire pressure should not exceed 15 psi. For soft sand conditions, reduce tire pressure to increase tire footprint.
6. **Wheels are not for highway use.**

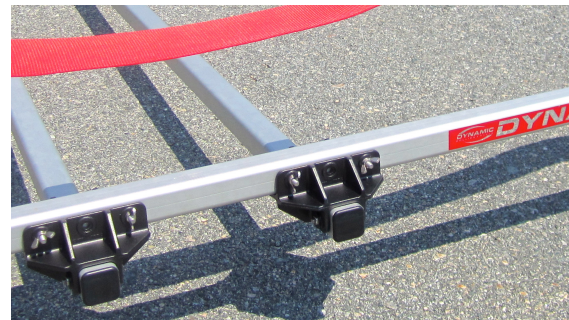

Wing Nuts for Quick Disconnect



Unsecured Snap Button



Snap Button Immobilized

Contact us:

401-683-0427, 275 High Point Ave, Portsmouth RI 02871
info@dynamicdollies.ocm

